

Omaxe Macrocosm

Over the past 21 years, Omaxe has established a permanent niche for itself in the real estate & construction sector by means of diverse range of well-planned residential and commercial projects. Today, Omaxe takes great pride in being a part of the dreams of millions across the nation and help them turn it into reality. The company at present has 53 projects under execution and planning. Among these are 21 integrated townships including a hi-tech city, 21 group housing projects, 9 shopping malls & commercial complexes and 2 hotels. No wonder, Omaxe holds the honor of being one of India's rapidly growing real estate developers. There are seven ongoing construction projects. Moreover, the company has already delivered 17 projects across the nation, covering sprawling 10.68 million sq. ft of total area, counting 9 group housing, 2 townships and 6 commercial projects.

Omaxe has progressed with leaps and bounds already making its presence felt in 30 cities and 9 states across the country. Trust comes tagged with the name Omaxe as is evident from the 120 contracting projects done for different institutions and organizations. Not to suffice, the quality system standards at Omaxe are at par with the best of the world that has helped the company evolve into a premier real estate development company. Visit your nearest office today because you truly deserve an Omaxe home.

1 sq. mt. = 10.764 sq. ft.



Location map

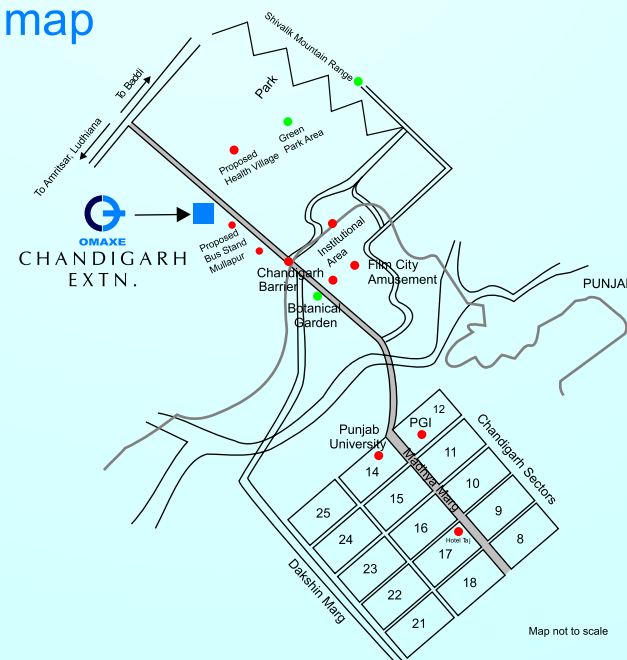

For Details Call : 09216925999, 09216926999



Chandigarh office address: SCO 143 -144, First Floor, Sec. 8-C, Madhya Marg, Chandigarh - 160



Presenting

INDIA
TRADE TOWER

Chandigarh Extn.

(A part of Global Business Park)

Why Chandigarh Extension?

The dream city of countless Indians and often referred to as The City Beautiful, Chandigarh, India's most well-planned city has all the reasons to extend its arms to a limit that not just gives it a scope for creating more residential opportunities but also allows it to extend its economic borders. And take a leap from its generations old business format to a revolutionary concept of the advanced, arresting and iconic business skyscrapers.

On one hand, where Chandigarh's internationally renowned architecture and urban planning are still driving people in, on the other, as the city is rapidly approaching its saturation point, the wide airy lanes have started to suffocate. Moreover, the popular neighborhoods like Mohali and Panchkula asking for hefty prices, there is a certain need of a city that can keep up to the commercial as well as residential expectations of all those who still look up to the city because of its extraordinary geography.

The foresight of Punjab Government and backed by in-depth research and master planning by the renowned Jurong International of Singapore have rightly gave birth to Punjab's first ever Eco-town Mullapur and A little Singapore in India, Chandigarh Extension.

A proposed sprawling 1000 acres of township that brings amazing business and residential prospects on the virgin greens of Mullapur.

CHANDIGARH EXTN.

PROPOSED 1000 ACRES TOWNSHIP

M U L L A P U R

A little Singapore in India



GLOBAL BUSINESS PARK

- Spread over sprawling 26 acres • International Business Hub
- International skyline in Chandigarh • 5 Star hotels • 5 Star plus Club
- Retail Space • Office Space • Invigorating a new work-eat-shop-fun culture in Punjab



INDIA
TRADE TOWER
Chandigarh Extn.

- Designed with up-to-the-minute technology • Stunning skyscraping G+19 floors • Covering extensive 2, 45,000 sq. ft space fully centrally air condition • 17 fully commercial floors embracing 1, 85,000 sq ft of space
- 42,000 sq ft space dedicated to shopping and retail • And a floor entirely covered with terrace podium, gym, food court and water body etc spread over 18,000 sq ft.

Global Business Park

Presenting the Global Business Park

A novel concept exceeding the in talk commercial districts of modern times that will leave you rambling in a web of some splendid business spaces in the form of extraordinarily designed offices and retail spaces, 5-star hotels and 5 star luxury club spread over yawningly wide 26 acres of land. Global Business Park is going to be a first-of-its kind 360 degree world-class international business hub that is set to add a new commercial skyline to the environs of Chandigarh invigorating a new work-eat-shop-fun culture in Punjab.

And to unveil this extensive package of business prospects, recreational opportunities and rich hospitality, Global Business Park unlocks its sky-scraping first business hi-rise

Proposed tower images





INDIA

TRADE TOWER

Chandigarh Extn.

Perspective view

India Trade Tower

An epitome of commercial brilliance, architectural excellence, geographical advantages and environmental beauty, India Trade Tower is primed to mark the beginning of a new economic era in the revolutionary town of Chandigarh Extension. Kissing the skies with its G+19 floor high stature, India Trade Tower is going to be the first ever bizz hi- rise of Punjab, that will make every hour of your day count, be it the office hours or a break for rejuvenation.



Perspective view



Office spaces so comfortable that may turn you workaholic



Architecture & Design that even the connoisseurs will admire



Food courts rich flowing with delicious recipes to help you re-collect yourself



Efficiently organized core and flexible lift clusters connecting 19 magnificent floors



Greater daylight penetration for buildings with scenic beauty to relish



Grand passages that provide fluency to walk-ins and outs

Spacious welcome lobbies with ambience enthused with hospitality

- Designed with up-to-the-minute technology
- Stunning skyscraping G+19 floors
- Covering extensive 2,45,000 sq. ft space fully centrally air-Condition
- 17 fully commercial floors embracing 1, 85,000 sq ft of space
- 42,000 sq ft space dedicated to retail
- Food and health club spread over 18,000 sq ft
- And a floor entirely covered with terrace podium, gym, food court and water body etc.

Advantages

- 5-star plus club spread over 40,000 sq ft
- Up coming 5 star Hotels, Business Suits and services apartments
- Upcoming Metro Line and Bus terminal in the vicinity
- 300 acres of health village near by
- Front with 200ft wide main road
- 8 mins. from PGI hospital
- 10 mins drive from prime areas like Sec.11
- Stones throw from Madhya Marg
- Saharanpur Industrial Area close at hand
- Plenty of residential options
- Approved by GMADA

Geographical benefits

This wonderful example of design and technology stands high amidst the strategically located township of Chandigarh Extension in Mullapur, backed by in-depth research and master planning by the renowned Jurong International of Singapore. Not just this, falling on the buzzing Madhyamarg, on one hand, where it offers proximity to prime locations of Chandigarh, on the other hand it looks around proudly to its well endowed environs, enjoying being a part of Punjab's first ever Eco-town.

There's plenty to come in the vicinity

- | | | | | |
|---------------------------|------------------|------------------|--------------------|--------------------|
| • Golf Course | • Spa Village | • Turf Club | • Lifestyle Sports | • Indoor Stadium |
| • Eco Park | • Sports Stadium | • Health Village | • Amusement Park | • Botanical garden |
| • 30 Kms of lush Greenery | | | | |

Disclaimer : All designs, perspectives, specifications, layouts, plans, features, facilities, etc. are indicative and are subject to change. Accessories shown in some of the pictures in this brochure, such as furniture, cabinets, electrical appliances, light fittings, paintings, wall and floor texture, etc. are indicative/decorative and are not part of the sale offered. This Brochure is purely conceptual and is not a legal offering. Further, the Promoters / Architects reserve the right to add/delete any details / specifications / elevations mentioned, if so warranted by the circumstances. Conditions apply

Typical floor plan

AREA DETAILS

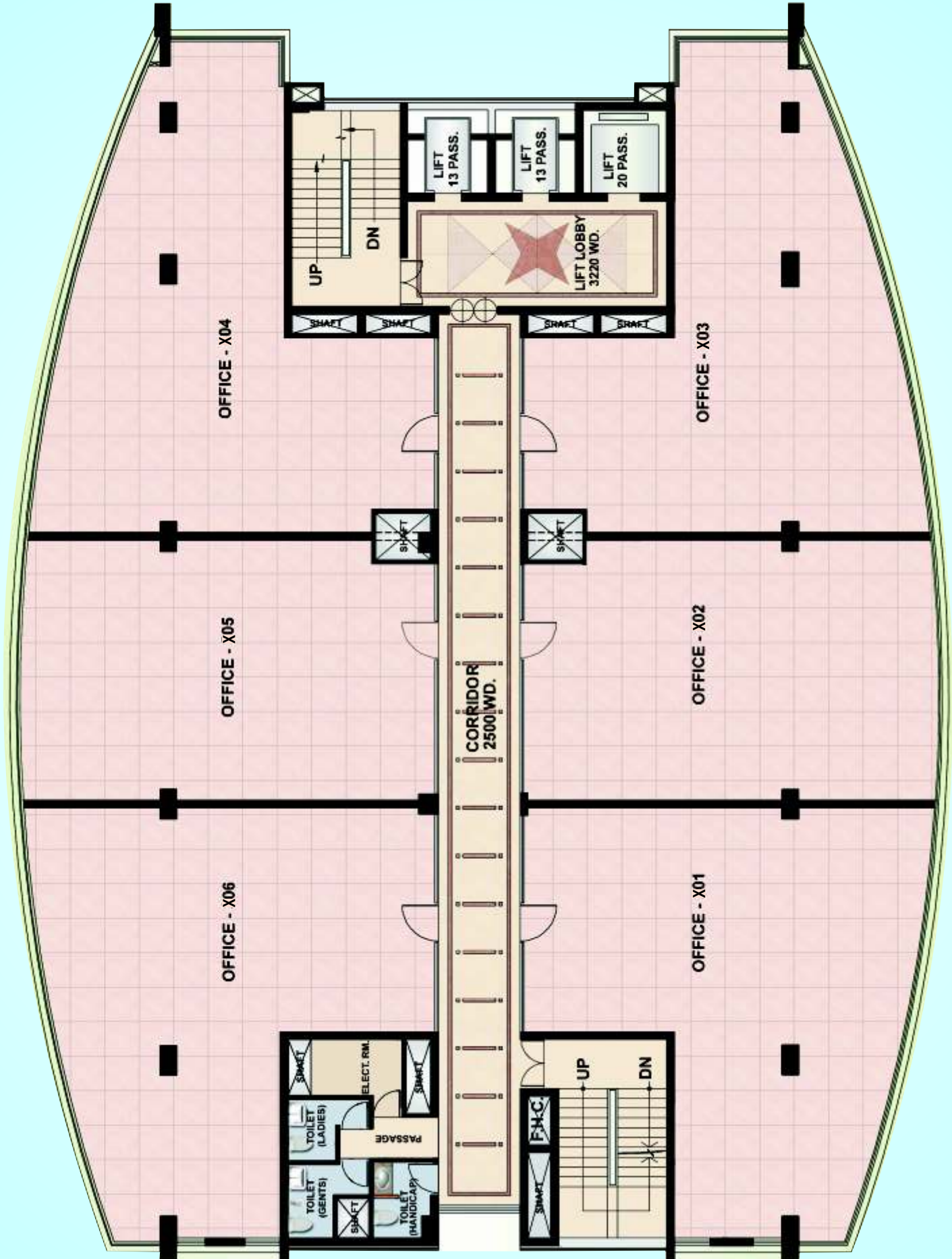

3RD FLOOR PLAN		
SHOP NO.	Super Area (In Sqmt)	Super Area (In Sqft)
OFFICE-301	199.83	2150.98
OFFICE-302	161.14	1734.49
OFFICE-303	197.03	2120.84
OFFICE-304	197.03	2120.84
OFFICE-305	161.14	1734.49
OFFICE-306	198.62	2137.90
Total	1114.78	11999.54

4TH FLOOR PLAN		
SHOP NO.	Super Area (In Sqmt)	Super Area (In Sqft)
OFFICE-401	200.32	2156.28
OFFICE-402	161.89	1742.61
OFFICE-403	199.48	2147.17
OFFICE-404	199.48	2147.17
OFFICE-405	161.89	1742.61
OFFICE-406	199.11	2143.20
Total	1122.17	12079.03

5TH FLOOR PLAN		
SHOP NO.	Super Area (In Sqmt)	Super Area (In Sqft)
OFFICE-501	200.57	2158.93
OFFICE-502	162.29	1746.91
OFFICE-503	200.88	2162.24
OFFICE-504	200.88	2162.24
OFFICE-505	162.29	1746.91
OFFICE-506	199.52	2147.67
Total	1126.43	12124.90

6TH FLOOR PLAN		
SHOP NO.	Super Area (In Sqmt)	Super Area (In Sqft)
OFFICE-601	200.62	2159.42
OFFICE-602	162.35	1747.58
OFFICE-603	201.09	2164.56
OFFICE-604	201.09	2164.56
OFFICE-605	162.35	1747.58
OFFICE-606	199.40	2146.34
Total	1126.91	12130.03

7TH FLOOR PLAN		
SHOP NO.	Super Area (In Sqmt)	Super Area (In Sqft)
OFFICE-701	200.45	2157.60
OFFICE-702	162.08	1744.60
OFFICE-703	203.08	2185.92
OFFICE-704	203.08	2185.92
OFFICE-705	162.08	1744.60
OFFICE-706	199.23	2144.52
Total	1129.98	12163.15

8TH FLOOR PLAN		
SHOP NO.	Super Area (In Sqmt)	Super Area (In Sqft)
OFFICE-801	200.45	2157.60
OFFICE-802	162.08	1744.60
OFFICE-803	200.94	2162.90
OFFICE-804	200.94	2162.90
OFFICE-805	162.08	1744.60
OFFICE-806	199.23	2144.52
Total	1125.71	12117.12

9TH FLOOR PLAN		
SHOP NO.	Super Area (In Sqmt)	Super Area (In Sqft)
OFFICE-901	199.65	2148.99
OFFICE-902	160.74	1730.19
OFFICE-903	193.74	2085.40
OFFICE-904	193.74	2085.40
OFFICE-905	160.74	1730.19
OFFICE-906	198.43	2135.91
Total	1107.03	11916.08

10TH FLOOR PLAN		
SHOP NO.	Super Area (In Sqmt)	Super Area (In Sqft)
OFFICE-1001	198.58	2137.56
OFFICE-1002	159.62	1718.10
OFFICE-1003	186.71	2009.72
OFFICE-1004	186.71	2009.72
OFFICE-1005	159.62	1718.10
OFFICE-1006	197.77	2128.79
Total	1089.00	11722.00

11TH FLOOR PLAN		
SHOP NO.	Super Area (In Sqmt)	Super Area (In Sqft)
OFFICE-1101	198.09	2132.27
OFFICE-1102	158.14	1702.20
OFFICE-1103	177.95	1915.50
OFFICE-1104	177.95	1915.50
OFFICE-1105	158.14	1702.20
OFFICE-1106	196.88	2119.18
Total	1067.15	11486.84

12TH FLOOR PLAN		
SHOP NO.	Super Area (In Sqmt)	Super Area (In Sqft)
OFFICE-1201	196.98	2120.34
OFFICE-1202	156.31	1682.50
OFFICE-1203	167.28	1800.57
OFFICE-1204	167.28	1800.57
OFFICE-1205	156.31	1682.50
OFFICE-1206	195.78	2107.43
Total	1039.94	11193.90

Tentative plan, subject to change

1 sq. mt. = 10.764 sq. ft.

AREA DETAILS

13TH FLOOR PLAN		
SHOP NO.	Super Area (In Sqmt)	Super Area (In Sqft)
OFFICE-1301	195.63	2105.77
OFFICE-1302	154.06	1658.32
OFFICE-1303	155.08	1669.25
OFFICE-1304	155.08	1669.25
OFFICE-1305	154.06	1658.32
OFFICE-1306	194.42	2092.69
Total	1008.32	10853.59
EFFICIENCY 65%		

15TH FLOOR PLAN		
SHOP NO.	Super Area (In Sqmt)	Super Area (In Sqft)
OFFICE-1501	192.00	2066.69
OFFICE-1502	148.14	1594.56
OFFICE-1503	126.75	1364.38
OFFICE-1504	126.75	1364.38
OFFICE-1505	148.14	1594.56
OFFICE-1506	190.78	2053.61
Total	932.57	10038.18

17TH FLOOR PLAN		
SHOP NO.	Super Area (In Sqmt)	Super Area (In Sqft)
OFFICE-1701	187.09	2013.86
OFFICE-1702	140.38	1511.10
OFFICE-1703	96.75	1041.46
OFFICE-1704	96.75	1041.46
OFFICE-1705	140.38	1511.10
OFFICE-1706	185.88	2000.78
Total	847.25	9119.76

NINETEENTH FLOOR PLAN				
SHOP NO.	Super Area (In Sqmt)	Super Area (In Sqft)	Terrace area (in Sqmt) @ 50%	Terrace area (in Sqft) @ 50%
OFFICE-1901	445.18	4791.97	126.45	1361.11
Total	445.18	4791.97	126.45	1361.11
EFFICIENCY 65%				

1 sq. mt. = 10.764 sq. ft.

SPECIFICATIONS

Structure	:	RCC frame work with raft foundation, in filler brick walls 230 / 115 thick, plastered on both sides. No plaster on ceiling.
Flooring	:	No flooring in shops / office area Common corridors / lift lobbies / Atrium to be finished with Granite stone/Vitrified tile/Combination of both in Shopping floors. Common corridors / lift lobbies to be finished with Granite stone/vitrified tile/combination of both in office floors. Toilets in Vitrified / antiskid ceramic tile. Basement with trimix flooring and interlock pavers. Service area with C.C flooring
External Façade	:	Structural Glazing/ACP/Granite
Lifts & Escalators.	:	Collective control, high speed elevators with glass on one face. Up & down escalators for ground to first and first to second floor.
External Development	:	Concrete roads / ramps with interlock pavers. Parking with grass pavers.
Electrical	:	One meter for one unit i.e. shop / office. Submains upto DB of each shop / office. (no electrical lighting / conduiting in offices / shop areas) Allotted electrical load as per area to each shop / office. Common corridors / lobbies / atrium / toilets / staircase with lights and 100% power backup. Provision of power back up as per area to each shop / office till the entry point. Dual metering system.
HVAC	:	Provision of allotted fixed tonnage to shops / offices. Common areas to be provided with complete HVAC system. (ducting only in common areas)
PHE	:	Vertical stacks in all shafts of UPVC for soil, waste, vent connection.
Fire Fighting	:	Provision of sprinkler main headers till entry of shops / offices Total fire fighting system as per N.B.C in common areas.